

Parts List						
Ref	Class	Part	Description	Qty	Comment	Footnote
1		862346T	BRACKET, Front Lifting Eye	1		
2	10	40108 20	SCREW, (M10 x 20)	2		
3	84	865457T04	HARNESS, Engine	1	(Mechanical Throttle and Shift)	
3	84	865653T02	HARNESS, Engine	1	(Digital Throttle and Shift)	
NS	84	865769T01	HARNESS, Transom	1	(Mechanical Throttle and Shift)	
NS	84	865676T01	HARNESS, Transom	1	(Digital Throttle and Shift)	
4		26079A 2	PLATE KIT, Wire Harness Mount, F	1		
5	10	15001	SCREW, (#8-16 x .875)	4		
6		862347T	BRACKET, Rear Lifting Eye	1		
7	10	40108 20	SCREW, (M10 x 20)	3		
8		816492A15	ALARM KIT	1		
9		891735	CAP, Weather Proof, 10 Pin Transc	1		

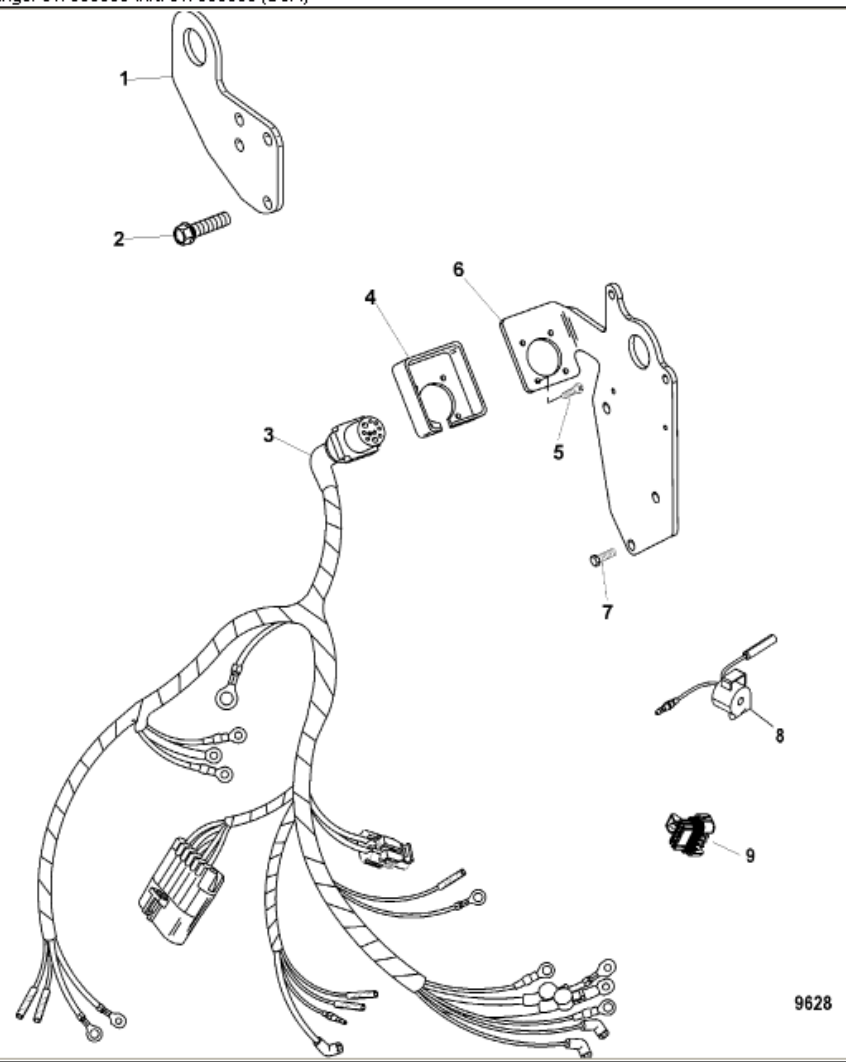

9628